

SHAW FOUNDATION ALUMNI HOUSE

VENUE RENTAL KIT

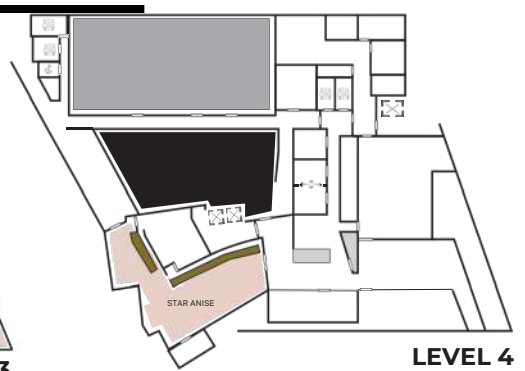

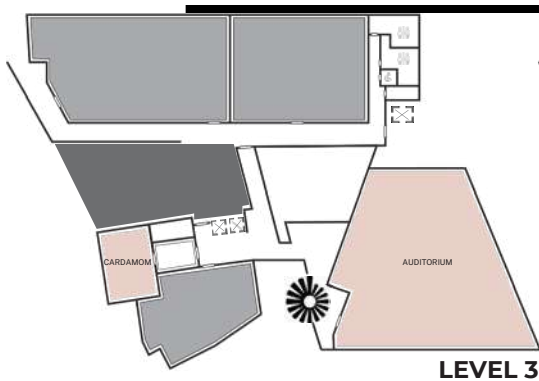
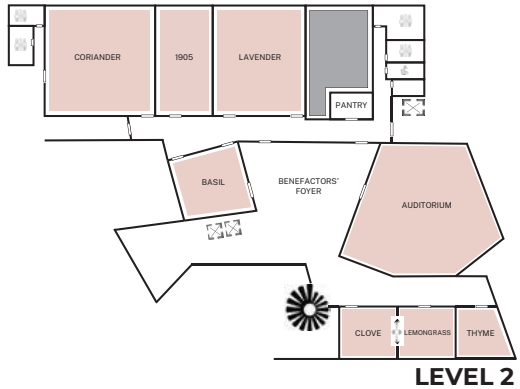
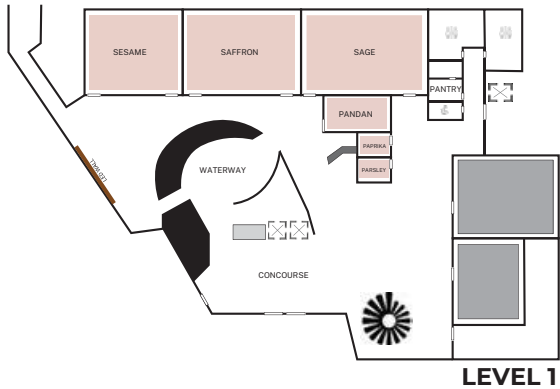

**SHAW
FOUNDATION
ALUMNI
HOUSE**

AUDITORIUM

505 SQ M

STAGE DIMENSION: 9.7 METER (L) X 4.4 METER (D)

HYBRID-CAPABLE



SEATING CAPACITY



298 pax
(standard)

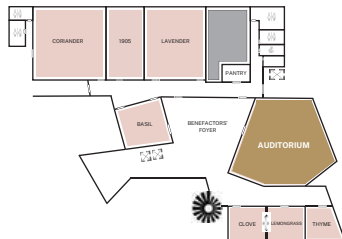

RENTAL RATES

Standard Package

Auditorium + Benefactors' Foyer
+ Thyme

4-Hour Block \$1,800

8-Hour Block \$3,500

Subsequent Hour \$480

Premium Package

Auditorium + Benefactors' Foyer
+ VIP Lounge 1905

4-Hour Block \$1,950

8-Hour Block \$3,650

Subsequent Hour \$520

*Booking time includes event set-up / rehearsal
and tear-down.*

RENTAL INCLUDES

Registration

2 x Skirted Oblong Tables
4 x Orange Cushion Chairs

Benefactors' Foyer

4 x Cocktail Tables

VIP Holding Room

5 x Single Seater Sofas
5 x Coffee Tables

Complimentary

1 x Audio-Visual Technician
Free Wi-Fi Access

Equipment

Laser DLP Projector (10,000 Lumens)
Sound System
1 x Rostrum with Gooseneck Mic
2 x Wireless Handheld Microphones
26 x Electrical Powerpoints

[CLICK HERE TO CHECK AVAILABILITY](#)



<https://alum.nus.edu.sg/fbs>

BENEFACTORS' FOYER

304 SQ M



SEATING CAPACITY



70 pax
(customised)



200 pax
(standing)

RENTAL RATES

4-Hour Block	\$700
8-Hour Block	\$1,300
Subsequent Hour	\$180

Booking time includes event set-up / rehearsal and tear-down.

RENTAL INCLUDES

- Equipment**
 - 2 x Skirted Oblong Tables
 - 4 x Orange Cushion Chairs
 - 4 x Cocktail Tables
 - 16 x Electrical Powerpoints

- Complimentary**
 - Free Wi-Fi Access

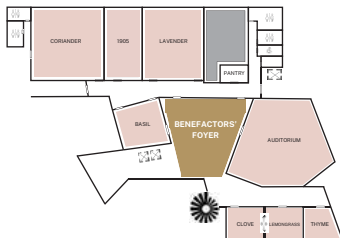

CLICK HERE TO CHECK AVAILABILITY

 <https://alum.nus.edu.sg/fbs>

VIP LOUNGE 1905

172 SQM PER ROOM



RENTAL RATES (PER ROOM)

4-Hour Block	\$500
8-Hour Block	\$950
Subsequent Hour	\$140

Booking time includes event set-up / rehearsal and tear-down.

RENTAL INCLUDES

Standard Setup

- 2 x Armchairs
- 2 x 3-Seater Sofas
- 1 x Cushioned Bench
- 1 x Round Table (with 6 x Cushioned Chairs)
- 1 x Rectangular Coffee Table
- 1 x TV Monitor
- 16 x Electrical Powerpoints

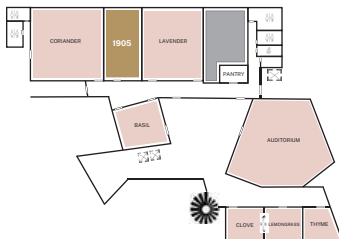

[CLICK HERE TO CHECK AVAILABILITY](#)



THYME

46 SQM PER ROOM

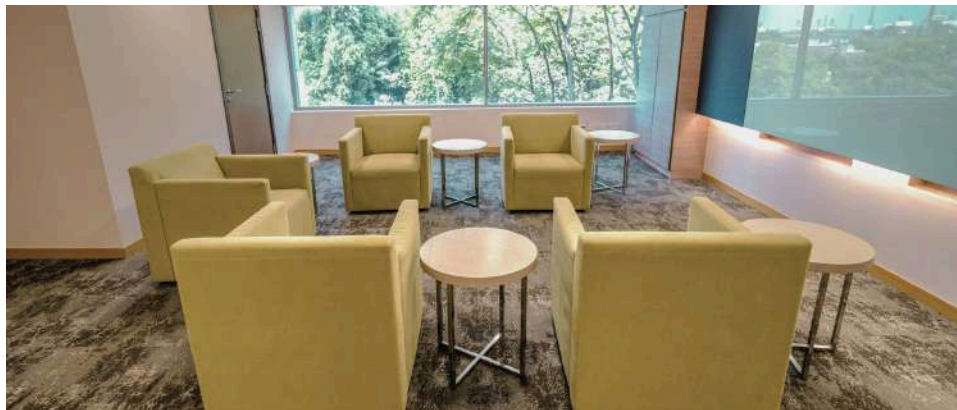

RENTAL RATES (PER ROOM)

4-Hour Block	\$180
8-Hour Block	\$350
Subsequent Hour	\$50

Booking time includes event set-up / rehearsal and tear-down.

RENTAL INCLUDES

 **Standard Setup**
5 x Single Seater Sofas
5 x Coffee Tables

 **Complimentary**
Free Wi-Fi Access

 **Equipment**
1 x Projector (5,000 Lumens)
1 x Projection Screen (2m x 2m)
8 x Electrical Powerpoints

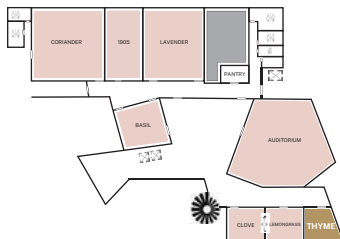

CLICK HERE TO CHECK AVAILABILITY



BASIL

95 SQ M

HYBRID-CAPABLE



SEATING CAPACITY



30 pax
(standard)



60 pax
(customised)

RENTAL RATES

4-Hour Block	\$350
8-Hour Block	\$680
Subsequent hour	\$100

Booking time includes event set-up / rehearsal and tear-down.

RENTAL INCLUDES

Standard Setup

- 30 Pax Cluster Style
- 1 x Registration Table & 2 x Chairs
- 1 x Presenter Table & 2 x Chairs

Complimentary

Free Wi-Fi Access

Equipment

- 1 x Projector (5,200 Lumens)
- 1 x Projection Screen (2m x 2m)
- 1 x Wireless Handheld Microphone
- 1 x Flipchart (with papers and markers)
- 10 x Electrical Powerpoints



[CLICK HERE TO CHECK AVAILABILITY](#)



CLOVE / LEMONGRASS

55 SQM PER ROOM
COMBINABLE ROOMS
HRBRID-CAPABLE



SEATING CAPACITY (PER ROOM)



40 pax
(standard)



20 pax
(customised)

RENTAL RATES (PER ROOM)

4-Hour Block \$350
8-Hour Block \$680
Subsequent hour \$100

Booking time includes event set-up / rehearsal and tear-down.

RENTAL INCLUDES (PER ROOM)

Standard Setup

40 Pax Theatre Style
1 x Registration Table & 2 x Chairs
1 x Presenter Table & 2 x Chairs

Complimentary

Free Wi-Fi Access

Equipment

1 x Projector (5,200 Lumens)
1 x Projection Screen (2m x 2m)
1 x Wireless Handheld Microphone
1 x Flipchart (with papers and markers)
8 x Electrical Powerpoints



[CLICK HERE TO CHECK AVAILABILITY](#)



<https://alum.nus.edu.sg/fbs>

CORIANDER

225 SQ M
HYBRID-CAPABLE



SEATING CAPACITY



80 pax
(standard)



100 pax
(customised)

VENUE RATES

4-Hour Block	\$500
8-Hour Block	\$950
Subsequent Hour	\$140

Booking time includes event set-up / rehearsal and tear-down.

RENTAL INCLUDES

Standard Setup

- 80 pax Cluster style
- 1 x Registration Table & 2 x Chairs
- 1 x Presenter Table & 2 x Chairs

Complimentary

- Free Wi-Fi Access

Equipment

- 2 x Projector (5,200 Lumens)
- 2 x Projection Screen (2m x 2m)
- 1 x Wireless Handheld Microphone
- 1 x Flipchart (with papers and markers)
- 26 x Electrical Powerpoints

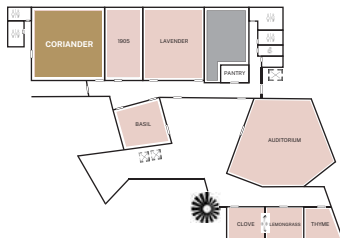

CLICK HERE TO CHECK AVAILABILITY



<https://alum.nus.edu.sg/fbs>

LAVENDER

184 SQ M
HYBRID-CAPABLE



SEATING CAPACITY



70 pax
(standard)



80 pax
(customised)

RENTAL RATES

4-Hour Block	\$500
8-Hour Block	\$950
Subsequent Hour	\$140

Booking time includes event set-up / rehearsal and tear-down.

RENTAL INCLUDES

Standard Setup

- 70 pax Cluster style
- 1 x Registration Table & 2 x Chairs
- 1 x Presenter Table & 2 x Chairs

Complimentary

- Free Wi-Fi Access

Equipment

- 1 x Projector (5,200 Lumens)
- 1 x Projection Screen (2m x 2m)
- 1 x Wireless Handheld Microphone
- 1 x Flipchart (with papers and markers)
- 30 x Electrical Powerpoints

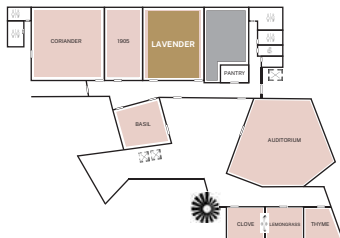

CLICK HERE TO CHECK AVAILABILITY



<https://alum.nus.edu.sg/fbs>

SAGE

142 SQ M
SOUND PROOFED
HRBRID-CAPABLE

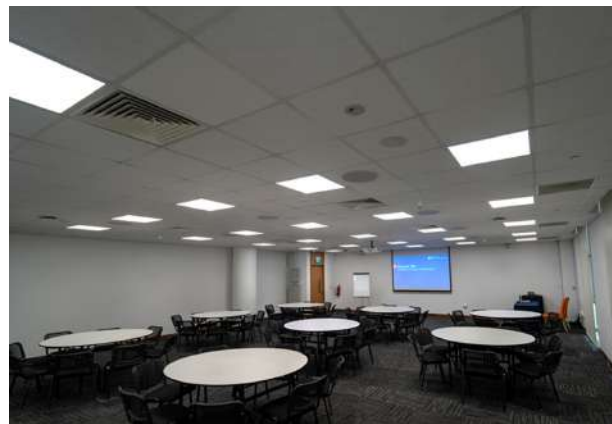

SEATING CAPACITY



60 pax
(standard)



70 pax
(customised)

RENTAL RATES

4-Hour Block \$500
8-Hour Block \$950
Subsequent Hour \$140

Booking time includes event set-up / rehearsal and tear-down.

RENTAL INCLUDES

Standard Setup

60 pax Cluster style
1 x Registration Table & 2 x Chairs
1 x Presenter Table & 2 x Chairs

Complimentary

Free Wi-Fi Access

Equipment

1 x Projector (5,200 Lumens)
1 x Projection Screen (2m x 2m)
1 x Wireless Handheld Microphone
1 x Flipchart (with papers and markers)
18 x Electrical Powerpoints

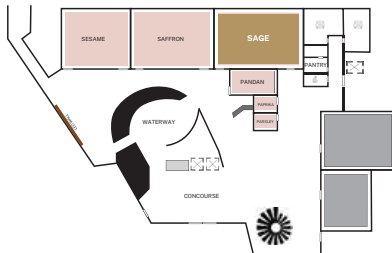

[CLICK HERE TO CHECK AVAILABILITY](#)



<https://alum.nus.edu.sg/fbs>

SAFFRON

160 SQ M

SOUND PROOFED
COMBINABLE WITH SESAME
HRBRID-CAPABLE



SEATING CAPACITY



100 pax
(standard)



72 pax
(customised)

RENTAL RATES

4-Hour Block \$500
8-Hour Block \$950
Subsequent Hour \$140

Booking time includes event set-up / rehearsal and tear-down.

RENTAL INCLUDES

Standard Setup

100 pax Theatre style
1 x Registration Table & 2 x Chairs
1 x Presenter Table & 2 x Chairs

Complimentary

Free Wi-Fi Access

Equipment

2 x Projector (5,200 Lumens)
2 x Projection Screen (2m x 2m)
1 x Wireless Handheld Microphone
1 x Flipchart (with papers and markers)
20 x Electrical Powerpoints

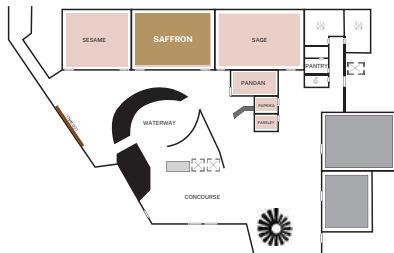

CLICK HERE TO CHECK AVAILABILITY



<https://alum.nus.edu.sg/fbs>

SESAME

105 SQ M

SOUND PROOFED
COMBINABLE WITH SAFFRON
HYBRID-CAPABLE



SEATING CAPACITY



60 pax
(standard)



30 pax
(customised)

RENTAL RATES

4-Hour Block	\$500
8-Hour Block	\$950
Subsequent Hour	\$140

Booking time includes event set-up / rehearsal and tear-down.

RENTAL INCLUDES

Standard Setup

- 60 pax Theatre style
- 1 x Registration Table & 2 x Chairs
- 1 x Presenter Table & 2 x Chairs

Complimentary

- Free Wi-Fi Access

Equipment

- 1 x Projector (5,000 Lumens)
- 1 x Projection Screen (2m x 2m)
- 1 x Wireless Handheld Microphone
- 1 x Flipchart (with papers and markers)
- 20 x Electrical Powerpoints

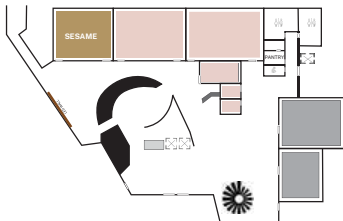

[CLICK HERE TO CHECK AVAILABILITY](#)



<https://alum.nus.edu.sg/fbs>

WATERWAY



SEATING CAPACITY



150 pax
(standing)



50 pax
(customised)

RENTAL RATES

4-Hour Block	\$700
8-Hour Block	\$1,300
Subsequent Hour	\$180

Booking time includes event set-up / rehearsal and tear-down.

RENTAL INCLUDES

Equipment

- 2 x Skirted Oblong Tables
- 4 x Orange Cushion Chairs
- 1 x LED Wall
- 4 x Cocktail Tables
- 16 x Electrical Powerpoints

Complimentary

- Free Wi-Fi Access

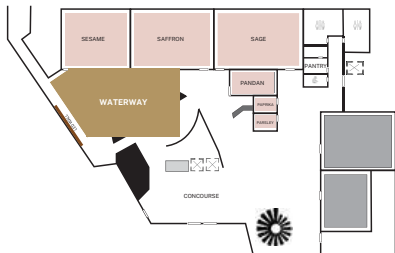

[CLICK HERE TO CHECK AVAILABILITY](#)



<https://alum.nus.edu.sg/fbs>

CONCOURSE

453 SQ M



SEATING CAPACITY



100 pax
(standing)

RENTAL RATES

4-Hour Block	\$700
8-Hour Block	\$1,300
Subsequent Hour	\$180

Booking time includes event set-up / rehearsal and tear-down.

RENTAL INCLUDES

- Equipment**
 - 2 x Skirted Oblong Tables
 - 4 x Orange Cushion Chairs
 - 4 x Cocktail Tables
 - 20 x Electrical Powerpoints

- Complimentary**
 - Free Wi-Fi Access

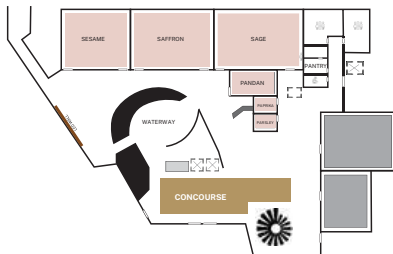

[CLICK HERE TO CHECK AVAILABILITY](#)



<https://alum.nus.edu.sg/fbs>

CARDAMOM



RENTAL RATES

4-Hour Block	\$500
8-Hour Block	\$950
Subsequent Hour	\$140

Booking time includes event set-up and tear-down.

RENTAL INCLUDES

🗋 Standard Setup

18 pax Boardroom style

🖨 Equipment

1 x Projector (5,000 Lumens)
1 x Projection Screen (2m x 2m)

🆓 Complimentary

Free Wi-Fi Access

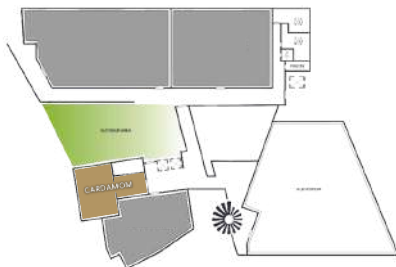

CLICK HERE TO CHECK AVAILABILITY



PANDAN



RENTAL RATES

4-Hour Block	\$180
8-Hour Block	\$350
Subsequent Hour	\$50

Booking time includes event set-up / rehearsal and tear-down.

RENTAL INCLUDES

📄 Standard Setup

- 12 pax Classroom style
- 1 x Presenter table

🖨 Equipment

- 1 x Projector (5,000 Lumens)
- 1 x Projection Screen (2m x 2m)

🆓 Complimentary

- Free Wi-Fi Access

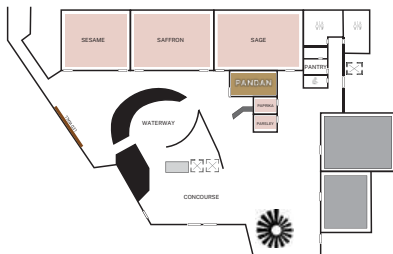

[CLICK HERE TO CHECK AVAILABILITY](#)



<https://alum.nus.edu.sg/fbs>

PAPRIKA / PARSLEY



RENTAL RATES

4-Hour Block	\$180
8-Hour Block	\$350
Subsequent Hour	\$50

Booking time includes event set-up and tear-down.

RENTAL INCLUDES

- Standard Setup
 - 6 pax Boardroom style
- Complimentary
 - Free Wi-Fi Access

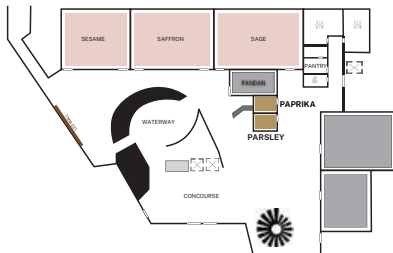

[CLICK HERE TO CHECK AVAILABILITY](#)



SPECIAL DISCOUNTS



**Alumni Network /
Student Group**



**NUS Alumnus /
Department / Staff /
Student**

Discount applies to venue rental only.

ADDITIONAL EQUIPMENT



Oblong Table (5ft x 2ft)	\$20/unit
Round Table (4ft or 5ft)	\$20/unit
Cocktail Table	\$15/unit
Wooden Coffee Table	\$10/unit



Chair with Writing Tablet	\$15/unit
Armrest Blue Chair	\$10/unit
Orange Cushion Chair	\$10/unit
Single Seater Sofa	\$15/unit
Double Seater Sofa	\$25/unit
High Stool	\$15/unit



Flip Chart with Papers	\$20/unit
Flip Chart Papers (50 papers)	\$15/unit
Whiteboard	\$20/unit



Wireless Handheld Microphone	\$50/unit
Lavalier Microphone Portable	\$80/unit
Portable AV Sound System	\$250/unit
Electric Extension Cord	\$5/unit
Portable TV	\$100/unit
Portable Stage (16ft x 16ft)	\$250/unit
Rostrum with Gooseneck Mic	\$100/unit
Electric Piano	\$300/unit
Stage Monitor	\$50/unit
Confidence Monitor (42 inch)	\$100/unit
Wireless Presenter	\$5/unit
Music Stand	\$5/unit
Microphone Stand	\$10/unit
Table Microphone Stand	\$10/unit
Mixing Console	\$100/unit



AV Support	\$60/hour/pax (min.4 hour required)
Cleaning Fee	\$50/room/day
Setup Fee (Customised Layout)	\$100/room/day
Removal Fee	\$25/mover

GETTING TO SHAW FOUNDATION ALUMNI HOUSE

11 KENT RIDGE DRIVE, SINGAPORE 119244

TRANSPORT BY TRAIN

Kent Ridge MRT (CC24), Exit A
Haw Par Villa Mrt (CC13), Exit A

BY BUS

Bus Stop: 16061 / 16069 10 / 30 /
51 / 143 183 / 188 / 200

CAR PARK

NUS Car Park 15 (In front of Temasek and Eusoff Halls)

OPERATING HOURS

Mon – Sat: 8 am to 10 pm

EMAIL

sfahvenue@nus.edu.sg

WEBSITE

